

CAT.C13: HANDLEBAR, CONTROLS FOR Q155/Q80

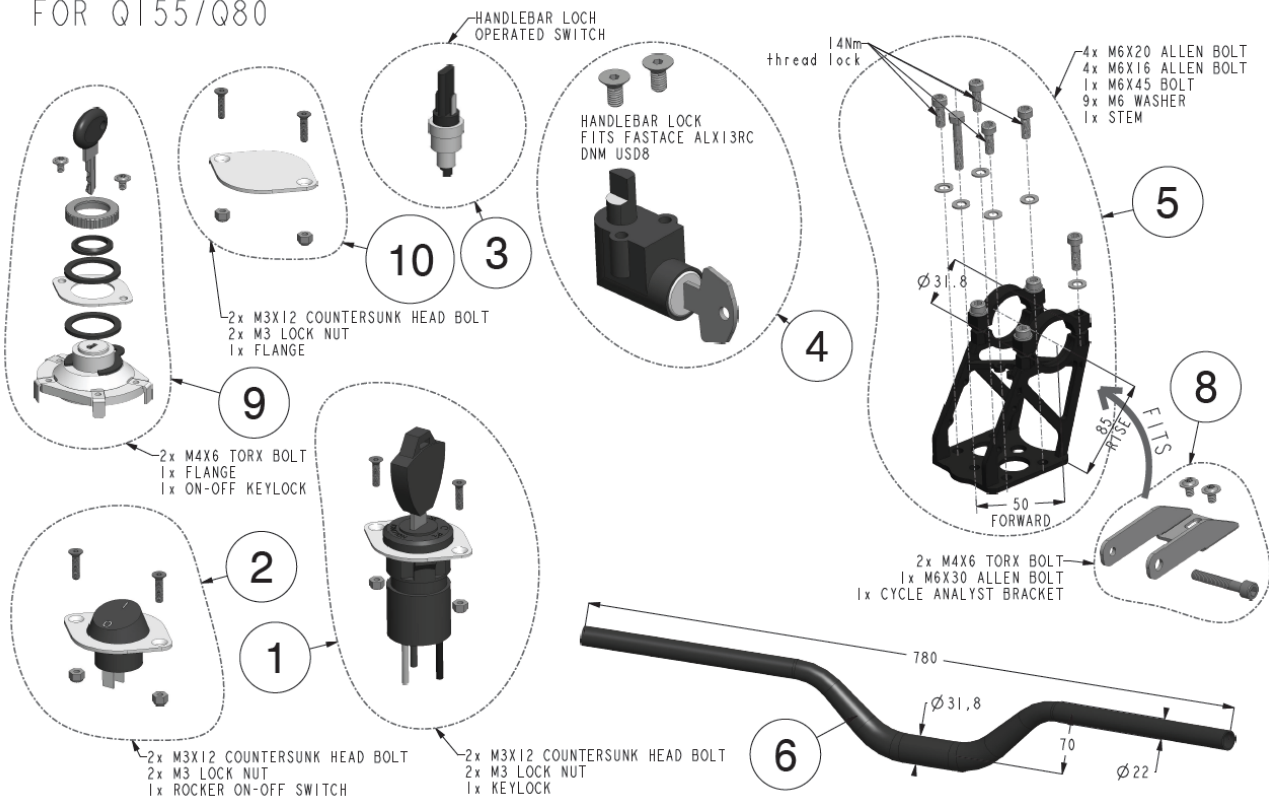

(9):

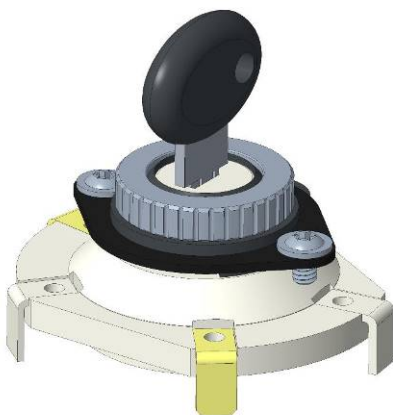

**Important Note:****Frame Compatibility:**

- Some frame versions may not have pre-cut threads in the mounting holes. If this is the case, use an M4 tap to cut threads in the two holes for the M4x6 Torx bolts.

Wiring Instructions:

- Connect the ignition line from the controller to one of the yellow pins (refer to the photo above).
- Connect the B+ (as configured on most controllers, but verify before proceeding) to the second yellow pin on the keyswitch.

Disclaimer: We are not responsible for any damage caused by incorrect wiring! Check with the controller manufacturer. Ensure all connections are checked thoroughly before powering on.